



This Quick Installation is meant to help you to install the product easily and quickly. For detailed instructions on installation, configuration, and further setup options, please consult the Technical Reference Manual.

Package Contents



- One Intelligent Telephone Adapter Model ITA-200
- One Power Adapter +12Volts DC, 500 mA
- One RJ-45 Ethernet Network Cable
- Quick Installation Guide

Intelligent Telephone Adapter Model ITA-200

Quick Installation Guide

1 Connect the ITA-200

- A** Before you begin, make sure that you have the setup information for your specific type of internet connection.
- B** Make sure that all of your network's hardware is powered off, including PCs, ITA-200, and cable or ADSL modem.
- C** Connect one end of the included Ethernet network cable to the WAN port, and the other end to the Ethernet port of the cable/ADSL modem or Ethernet connection.
- D** Connect one end of another Ethernet network cable to the LAN port of the device, and the other end to the Ethernet adapter on your PC.
- E** Connect two analogue telephone sets to the Phone ports 1 & 2.
- F** Connect the AC Power Adapter to the Power and the other end into an electrical outlet.
- G** Power on the following devices in this order: PC, ITA-200 and cable or ADSL modem, router.

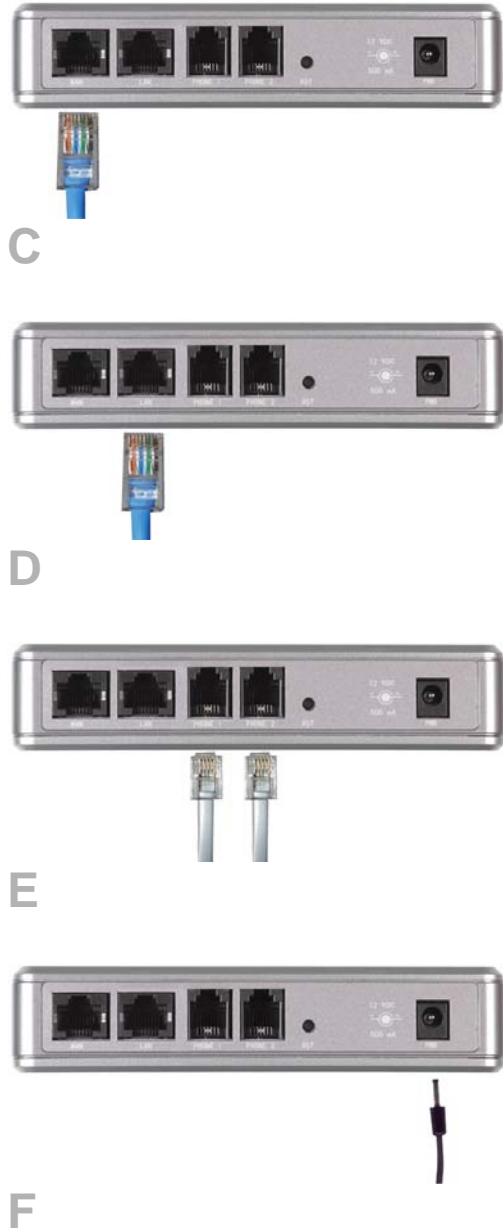

Important:

Make sure to use the power adapter that is supplied with ITA-200. The use of different power adapter could damage the ITA-200.

2 Configuring the ITA-200

These instructions will show you how to configure the ITA-200.

A Open the web browser in your PC. Enter `http://192.168.10.1` in its Address field. Press the Enter key.

B A login screen will appear. Enter the default Username, `admin` and Password, `admin`, in lowercase letters in the Username and Password fields. (For added security, you should later set a new password in the Maintenance tab). Then click the Login button.

C For the WAN/ LAN Configuration, three connections types are offered though the drop-down menu. Each setup screen and available features will differ depending on which connection type you select.

Internet Configuration Type

Automatic Configuration – DHCP: If you are connecting through DHCP or a dynamic IP address from your ISP, keep this default setting. (C1)

Static: If your ISP assigns you a static IP address, select Static IP from the drop-down menu. Complete the Internet IP address, Subnet Mask, Gateway and DNS fields. You need to enter at least one DNS address. (C2)

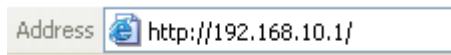

A



B

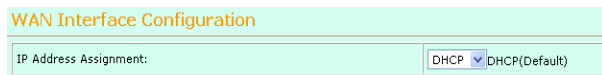

C1

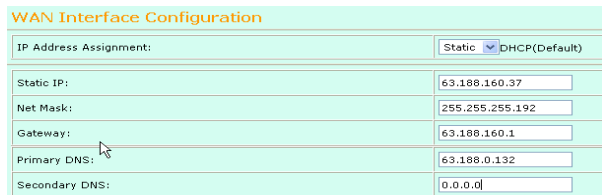

C2

ITA-200 Quick Installation Guide

PPPoE: if you are connecting through PPPoE, select PPPoE from the drop-down menu. Complete the Username and Password fields. (C3)

D When you are finished entering your Internet connection settings, click on the Update button to save your changes.

E If the user wants to obtain full access to all the web pages to configure SIP and other server information, he has to enter the super password in the password field. Super password is created using the following combination, the last 2 digits of the MAC address plus the 7th and 8th digits of the MAC address followed by **ieta200**.

For example:

MAC address = 000f26001f88
the password will be **8800ieta200**
password is in lower case.

To configure the VoIP Number, go to the SIP Configuration tab. Enter the SIP Proxy, VoIP number and password field. Click on the Update button to apply your changes.

F Reset ITA-100 to save the settings.

| WAN Interface Configuration | |
|-----------------------------|---------------------|
| IP Address Assignment: | PPPoE DHCP(Default) |
| Login: | ta200 |
| Password: | ***** |

C3

InterEdge
TA-200

Unit Information | WAN/LAN Configuration | **SIP Configuration** | Services | Misc. Servers | Maintenance

SIP Server Information (Primary)

Sip Proxy Server 1: 111.222.333.444 Port #: 15060 Enable:

Sip Domain/Registration Server 1: 111.222.333.444 Interval(s): 1200

Local Sip Port: 5060 Nat Timer(sec): 15 Enable:

SIP Server Information (Secondary for Backup)

Sip Proxy Server 2: 0.0.0.0 Port #: 0 Enable:

Sip Domain/Registration Server 2: 0.0.0.0 Interval(s): 0

Local Sip Port: 5060 Nat Timer(sec): 0 Enable:

SIP Client Information

Telephone #1 - Enable:

User ID 1: 1234567 Password: ***** Display Name 1: 1234567

Authentication ID 1: 1234567 Enable:

Vocoder List Telephone 1

Code: # 1: G.723.1 Code: # 2: G.711/PCMU Code: # 3: G.729 Code: # 4: G.729A

Fax Codec: T30 V30 Voice Frame per/IP Packet: 4 1-20 Default (4) Silence Sup:

Media Port: 27000 1024 to 65535 Default (27000)

Handset 1 Volume(Speaker): 6 dB Default 0 dB(Med) Handset 1 Volume(Mic): 6 dB Default 0 dB(Med)

Telephone #2 - Enable:

User ID 2: 7654321 Password: ***** Display Name 2: 7654321

Authentication ID 2: 7654321 Enable:

Vocoder List Telephone 2

Code: # 1: G.723.1 Code: # 2: G.711/PCMU Code: # 3: G.729 Code: # 4: G.729A

Fax Codec: T30 V30 Voice Frame per/IP Packet: 4 1-20 Default (4) Silence Sup:

Media Port: 27000 1024 to 65535 Default (27000)

Handset 2 Volume(Speaker): 6 dB Default 0 dB(Med) Handset 2 Volume(Mic): 6 dB Default 0 dB(Med)

Update

InterEdge Telephone Adaptor V1.0
Copyright (c) 2004 InterEdge Technologies, All Rights Reserved.

E